



In-Tank Filters Disposable Filter Cartridge Type

Return Line Application

Model "LIT" Series LIT-500, 750, 1000, 1250

Specifications

- Working pressure 100 P.S.I. (7 Bar)
- Operating Temperatures -22° F to +212° F (-32° C to +100° C)
- Flows to 25 GPM (96 LPM) Return
- 1/2", 3/4", 1", Ports Aluminum casting
- Buna Seals
- Compatible with mineral oils HH, HL, HM, HR, HV, HG according to ISO 6743/4
- Nylon bowl
- 3-10 (lbs), 1.4-4.5 (kgs) shipping weight
- 25 P.S.I.D. bypass option for return
- Magnet on lid

Options

- NPT or SAE Ports
- 10, 25 micron cellulose, synthetic elements
- Visual or electrical indicators
- Weld Riser Available for LIT-750, 1000 Series
(see Tech Bulletin: TB.FIL.06.708)



LIT-500/750/1000



LIT-752-10



LIT-750-R-WR

LIT-500

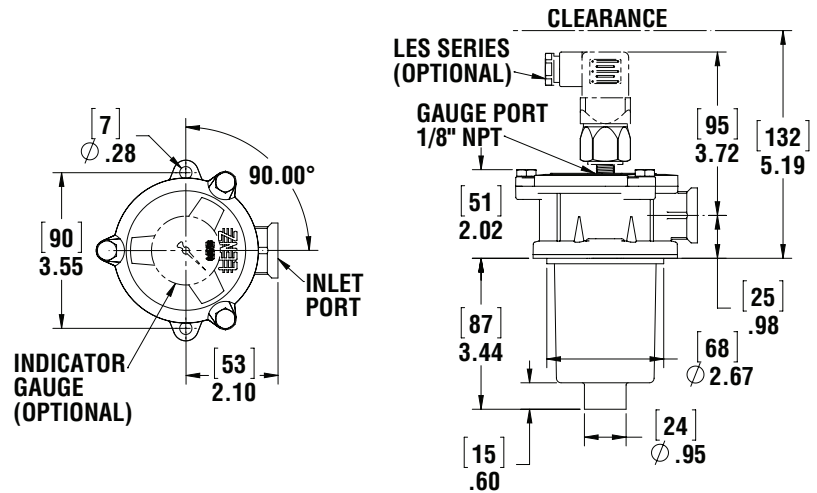

LIT-750, LIT-1000, LITXL-1000,

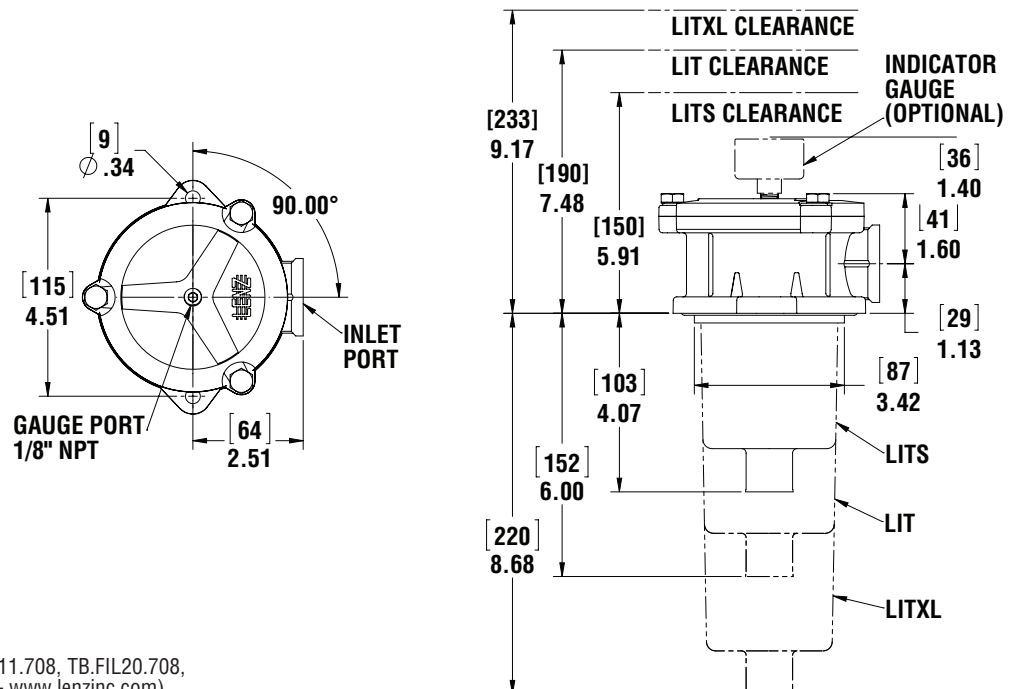

See Technical Bulletin TB.FIL9.708, TB.FIL11.708, TB.FIL20.708, for further information at (Technical Data – www.lenzinc.com)

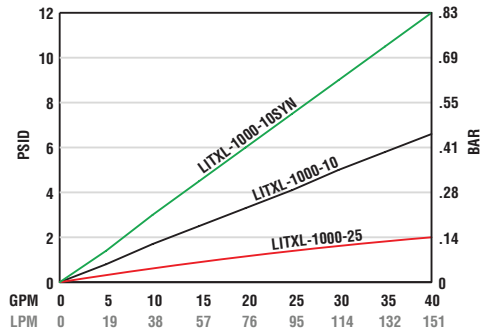
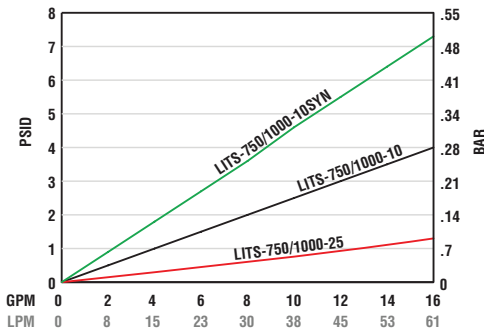
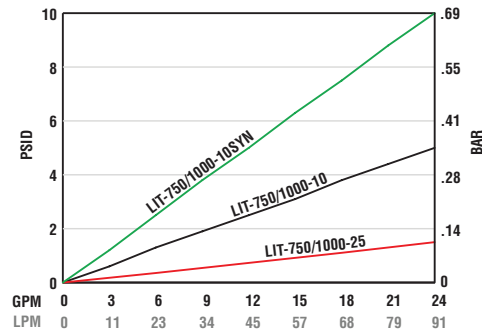
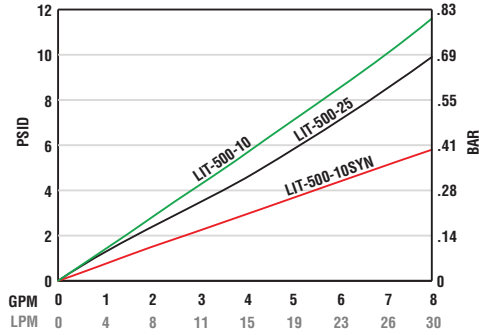

Temperature 100° F Viscosity 150 SUS
Average pressure drop through clean assembly

Assembly Ordering Code

LIT - 750 - 10 - P - T

SERIES	
LIT	NPT
LITA	SAE
LITS	SHORT (750 only)
LITXL	LONG (1000 only)

MODEL	PORT SIZE
500	1/2"
750	3/4"
1000	1"

MEDIA	MODEL
10	10 MIC CELLULOSE
10SYN	10 MIC SYNTHETIC
25	25 MIC CELLULOSE

BYPASS	
P	(25 P.S.I.)

IND. PORTS	
OMIT	NONE
T	1/8 NPT RETURN

For indicator gauge specifications and ordering information see pages 34a-35a



Replacement Elements

FILTER MODEL	ELEMENT NUMBER	MEDIA	IN	CM	B=2/20/75	DIRT HOLDING CAPACITY
LIT-500	LIT502-10P	10 MICRON CELLULOSE	110	710	6μ/8μ/13μ	3
	LIT502-25P	25 MICRON CELLULOSE	110	710	24μ/35μ/43μ	4
	LIT502-10SYN	10 MICRON SYNTHETIC	78	500	3μ/5.5μ/12μ	4
LITS-750, 1000	LITS-752-10P	10 MICRON CELLULOSE	190	1225	6μ/8μ/13μ	6
	LITS-752-25P	25 MICRON CELLULOSE	190	1225	24μ/35μ/43μ	8
	LITS-752-10SYN	10 MICRON SYNTHETIC	136	875	3μ/5.5μ/12μ	8
LIT-750, 1000	LIT-752-10P	10 MICRON CELLULOSE	380	2450	6μ/8μ/13μ	11
	LIT-752-25P	25 MICRON CELLULOSE	380	2450	24μ/35μ/43μ	15
	LIT-752-10SYN	10 MICRON SYNTHETIC	271	1750	3μ/5.5μ/12μ	16
LITXL-1000	LITXL-1002-10P	10 MICRON CELLULOSE	620	4000	6μ/8μ/13μ	19
	LITXL-1002-25P	25 MICRON CELLULOSE	620	4000	24μ/35μ/43μ	25
	LITXL-1002-10SYN	10 MICRON SYNTHETIC	450	2900	3μ/5.5μ/12μ	27

Suggested tightening gauge to mount filter to reservoir is 8ft.lbs (11)NM

Beta Rating of 2 = 50% Efficiency
Beta Rating of 20 = 95% Efficiency
Beta Rating of 75 = 98.7% Efficiency
Note: 45 P.S.I. Pressure Drop Maximum Without Bypass Valve In Filter Head



2" Diameter Filter Indicating Gauges



MC-12
Return Line Indicating Gauge
for **15 P.S.I.** Filter Applications
2" Multi color
0-12 P.S.I. Green
12-15 P.S.I. Yellow
15-60 P.S.I. Red (Service Filter)
(To be used with "T" Indicator Port Location)

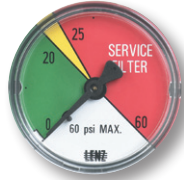

MC-20
Return Line Indicating Gauge
for **25 P.S.I.** Filter Applications
2" Multi color
0-20 P.S.I. Green
21-24 P.S.I. Yellow
25-60 P.S.I. Red (Service Filter)
(To be used with "T" Indicator Port Location)



CP-2
Compound Indicating Gauge
(Suction or Return Line)
10" to 30" Vacuum is a Red Danger Area.
0-60 PSI
A Red "Change Filter" Sticker for the
Pressure side is included with each gauge
for application after the pressure factor
is determined.
(To be used with "T" or "S" Indicator Port Location)



GLY-MC-20
Glycerin Filled
Return Line Indicating Gauge
for **25 P.S.I.** Filter Applications
2" Multi color
0-20 P.S.I. Green
21-24 P.S.I. Yellow
25-60 P.S.I. Red (Service Filter)
(To be used with "T" Indicator Port Location)



135080
Suction Line Indicating Gauge for
5 P.S.I. vacuum filter application
2" Multi color
0-9" HG Green
9-11" HG Yellow
11-30" HG Red (Service Filter)
(To be used with "S" Indicator Port Location)



VAC-3-20
Suction Line Indicating Gauge
for **3 P.S.I.** vacuum filter applications
2" Multi color
0-3" HG Green
4-6" HG Yellow
6-30" HG Red (Service Filter)
(To be used with "S" Indicator Port Location)



Differential Indicator DP-75

Simple differential sliding
indicator which changes from
green to red at 7 P.S.I.D.
0 - 7 P.S.I.D. Green Clean
7 - 10 P.S.I.D. Red Service Filter
CP Series (500, 750, 1010, 1280,
1580)



Electrical Filter Indicators

Field Adjustable

Specifications:

- 1/8 NPT connection
- 3 AMP 12/24 VDC, 125/250 VAC IP67
- +/- 2% repeatability of full set point range @ 70° F
- Operating temperature 40°F to +250°F (-40°C to 121°C)
- 1,000,000 cycles mechanical range
- Maximum pressure 500 (25 BAR) PSI
- Steel housing, zinc plated
- Buna N diaphragm
- SPDT snap action switch

Options:

- EPDM seals -10°F – 250°F (-23°C – 121°C)
- Viton seals 0 – 250°F (-18°C – 121°C)
- Flying leads



LES-FL



LES-HC

MODEL	ADJUSTMENT RANGE	AVERAGE DIFFERENTIAL	SET PRESSURE
P1	3-20 PSI (.2-1.4 BAR)	2-5 PSI (.13-0.4 BAR)	15 PSI
P2	15-80 PSI (1.03-6 BAR)	4-7 PSI (.27-0.5 BAR)	22 PSI
V1	5-28 IN Hg (160-948mb)	2-4 INHg (67-135mb)	5 Hg

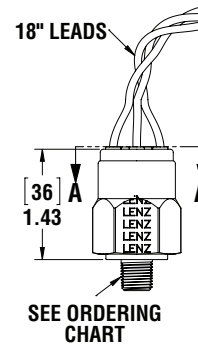
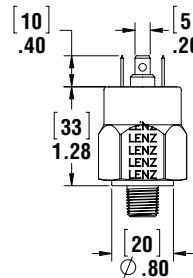
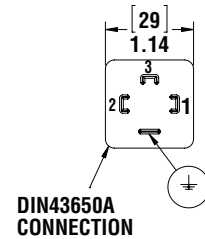
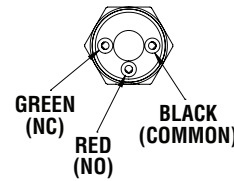
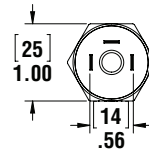

LES-FL

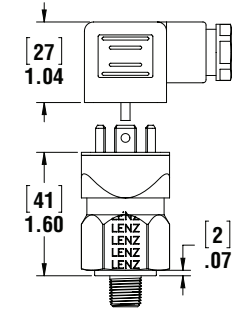

LES-HC

Switch Ordering Code

LES - P1 - 2N - B - HC -

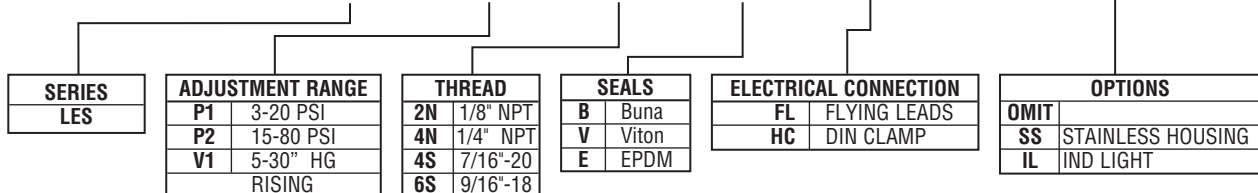

Switch can be used in AC or DC Service.
For other options consult factory.

See Technical Bulletin TB.FIL23.912, or further information at
(Technical Data – www.lenzinc.com)